

## Outdoor Mounting Kit - Air Heater (VF80CE Model)



### DESCRIPTION:

This is an accessory (CF0689) designed to mount a single air heater outdoors. Follow all installation and operation instructions supplied with each heater for Warnings, Clearances to Combustibles, Electrical/Gas Connections and all other pertinent information not shown in these instructions.

**If the agricultural air heater is installed outdoors it must be mounted a minimum of 24 inches above the ground.**

The fastener kit includes hardware used to secure the mounting brackets to standard wall material having 16 in. (406mm) and 24 in. (610mm) stud centers. If the walls are constructed of materials different from these additional hardware may have to be purchased locally to install the heater secure and safe.

Fastener Kit No. 42907991

Item No.	Part No.	Description	Qty.
A	02192010	Screw, Hex Washer Head #10 x 1/2"	4
B	02189030	Screw, Hex Washer Head #8 x 1/2" self-drilling	8
C	02203080	Screw, Hex Washer Head #8 x 3/4"	4
D	30810010	Hole Plug - Domed Head	4
E	02198020	Locknut, Hex 3/8-16 (with nylon insert)	4
F	02271020	Lag Screw, 3/8 x 4"	4
G	02129140	Washer, Flat 3/8"	8
H	30347040	Spacer, 1" O.D.	4
I	02200110	Carrage Bolt 3/8-16 x 1-3/4"	4
J	02112010	Screw, Hex Head 3/8-16 x 1/2"	6
K	02127130	Nut, Hex 3/8-16	6
L	02130130	Lockwasher, Spring 3/8"	6
M	43647100	Instruction Sheet (not shown)	1

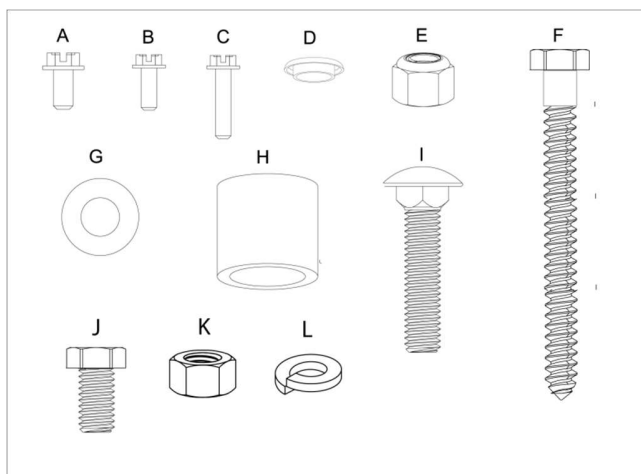

## Outdoor Mounting Kit - Air Heater (VF80CE Model)



### Outdoor Mounting Kit - (CF0689)

Item No.	Part No.	Description	Qty.
A	44609010	Top Cover Panel	1
B	44609060	Wall Mount Support Bracket - Angled	2
C	44609070	Wall Mount Support Bracket - Top	2
D	44609080	Wall Mount Support Bracket - Wall	2
E	44608000	Duct Assembly - (shipped seperately)	1
F	44608010	Duct - Face Plate	1
G	44608040	Duct Trim - Air Discharge (optional)	4
H	44609090	Duct Trim - Connector (optional)	2
I	42907991	Fastener Kit (shown above)	1

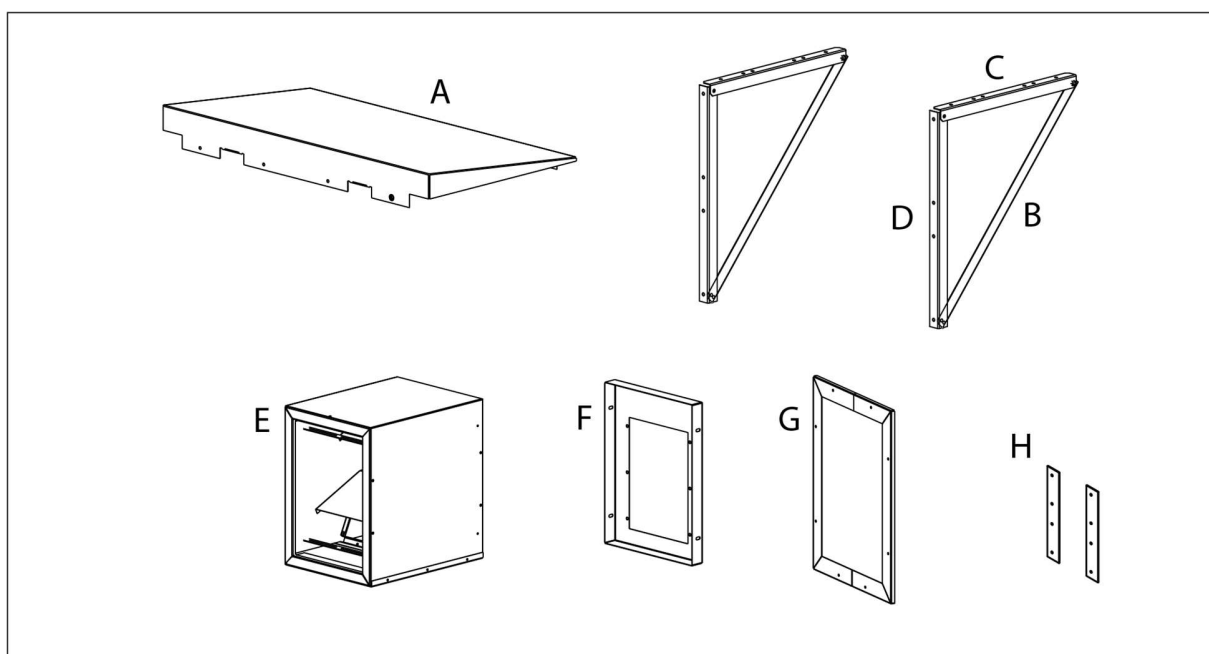

### OUTDOOR MOUNT (overview)

The figure below is an overview showing all components in the complete installation of the outdoor mounting kit. Refer to the following instructions for step by step assembly.

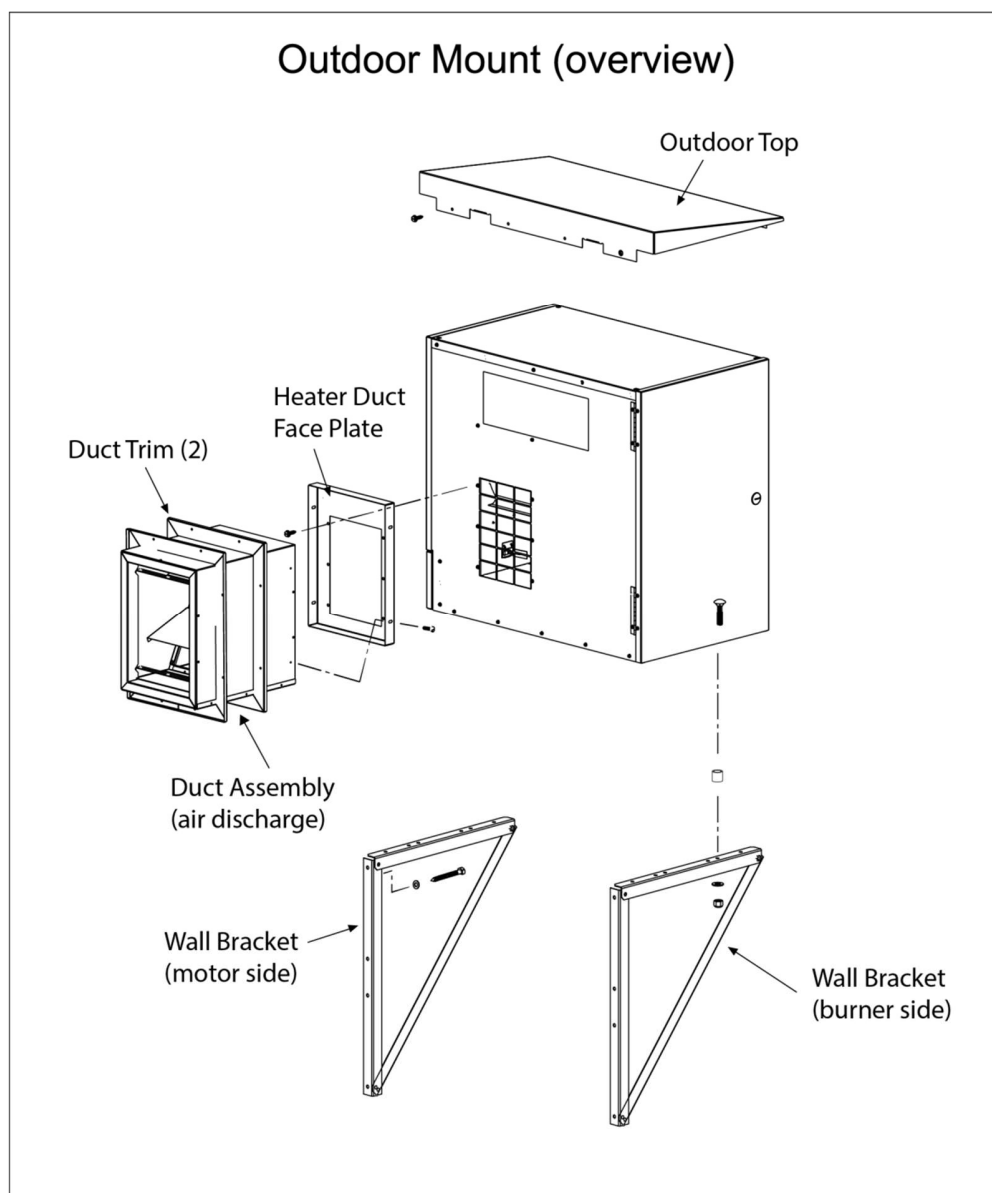

### ADDING THE DUCT ASSEMBLY TO THE HEATER

1. Remove the (6) screws located at the blower discharge screen.
2. Apply a bead of silicone sealant around the back side of the heater duct face plate.
3. Attach the duct face plate over the area of the discharge screen using the (6) screws removed above. Note: The wide area of the duct face plate is oriented at the top.

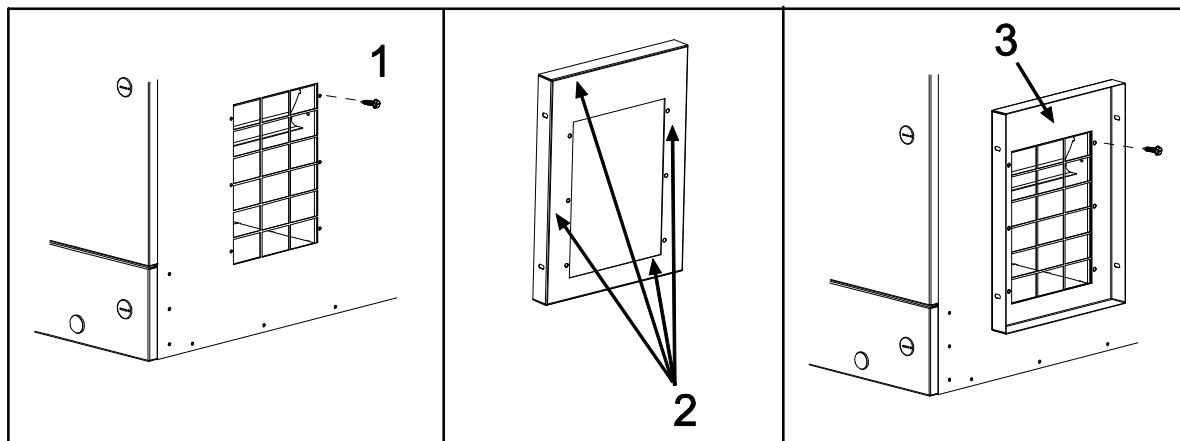

4. Secure the upper portion of the duct flange using the #10 x 1/2" sheet metal screws supplied in the fastener kit.
5. Apply a bead of silicone sealant around the inside corners of the heater duct face plate.

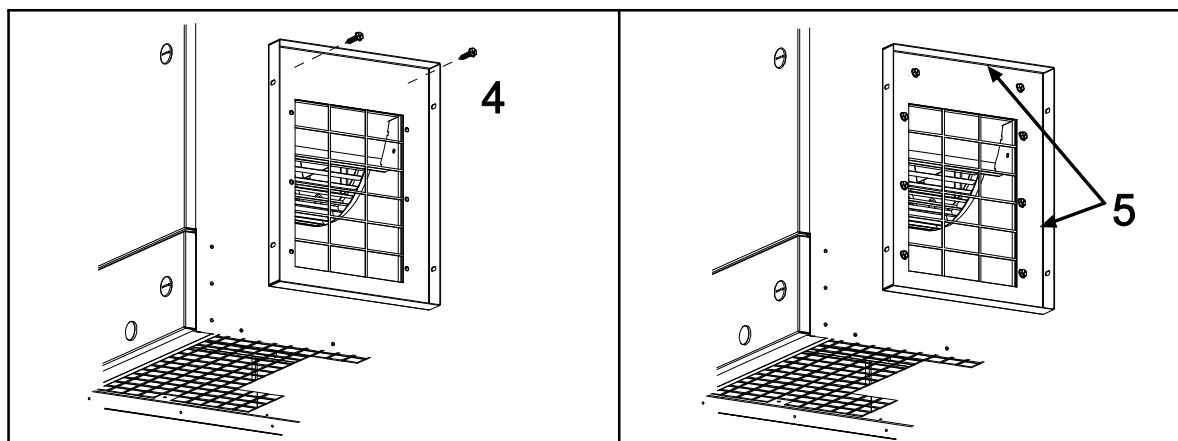

6. Slide the duct assembly (air discharge) into the duct face plate. Press the duct assembly snug against the silicone sealant added above. Note: The damper flaps must be positioned so they lift up as the air is discharged.
7. Use (4) #8 x 3/4" long sheet metal screws supplied in the fastener kit to secure the duct assembly to the duct face plate.

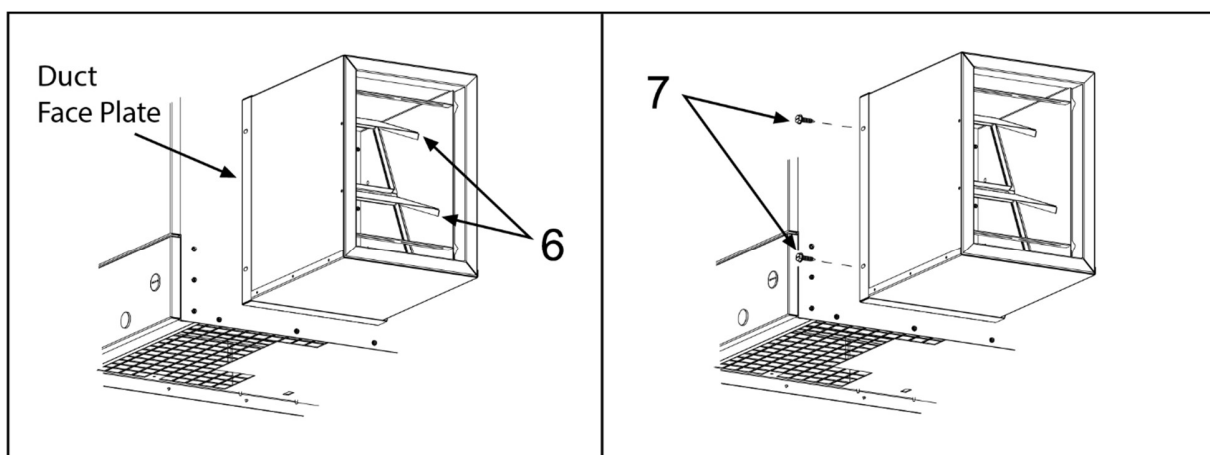

### INSTALLING OPTIONAL DUCT TRIM

- 7a. Assemble the exterior trim pieces and connectors using (4) #8 x 1/4" sheet metal screws. **NOTE: Trim pieces are not required for proper operation of an air heater mounted outdoors.**

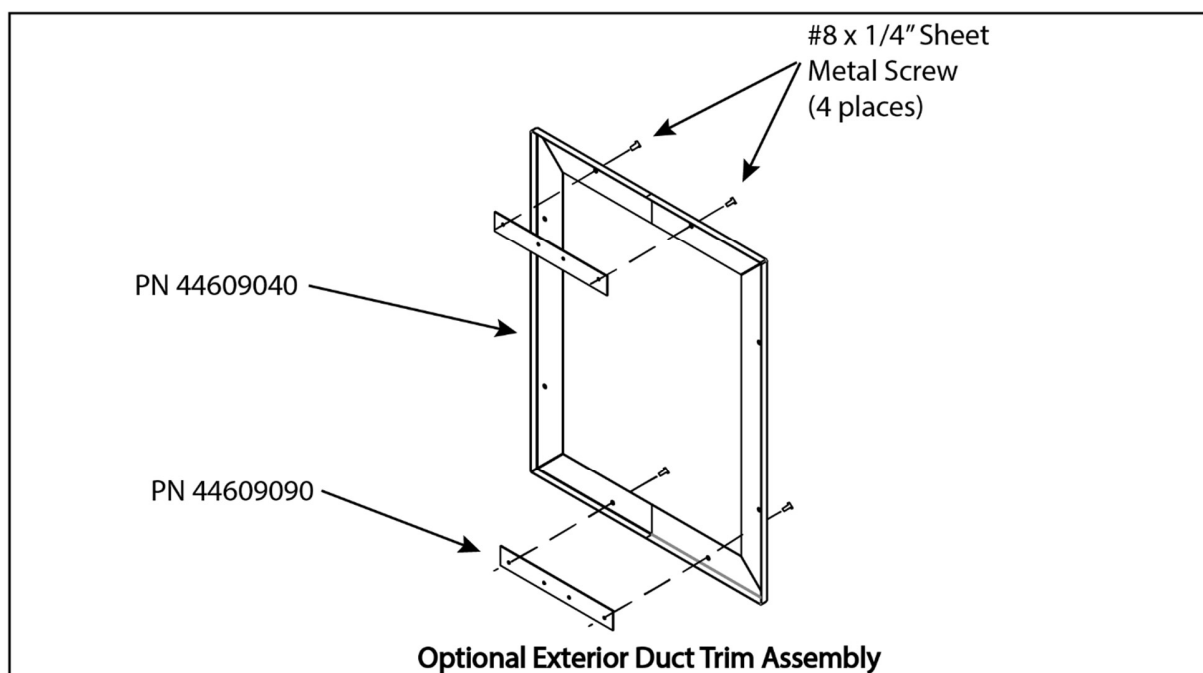

- 7b. Install the exterior trim pieces on the duct assembly (air discharge) with the flanges facing toward the exterior wall. Use construction adhesive, silicone, etc. to attach the trim to the exterior wall. Interior trim can be installed using supplied #8 x  $\frac{3}{4}$ " screws or construction adhesive, silicone, etc.

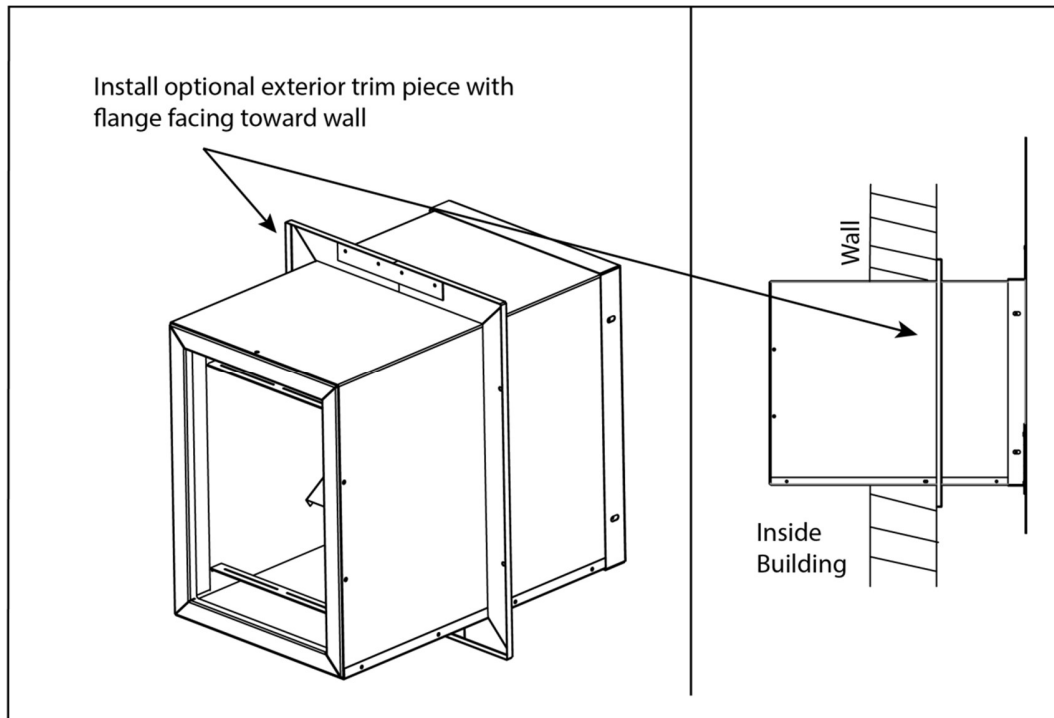

### ADDING THE TOP COVER PANEL TO THE HEATER

8. Remove the (4) retainer nuts (if equipped) from the top panel of the heater using a screwdriver.
9. Plug the holes using the dome head plugs supplied in the fastener kit.

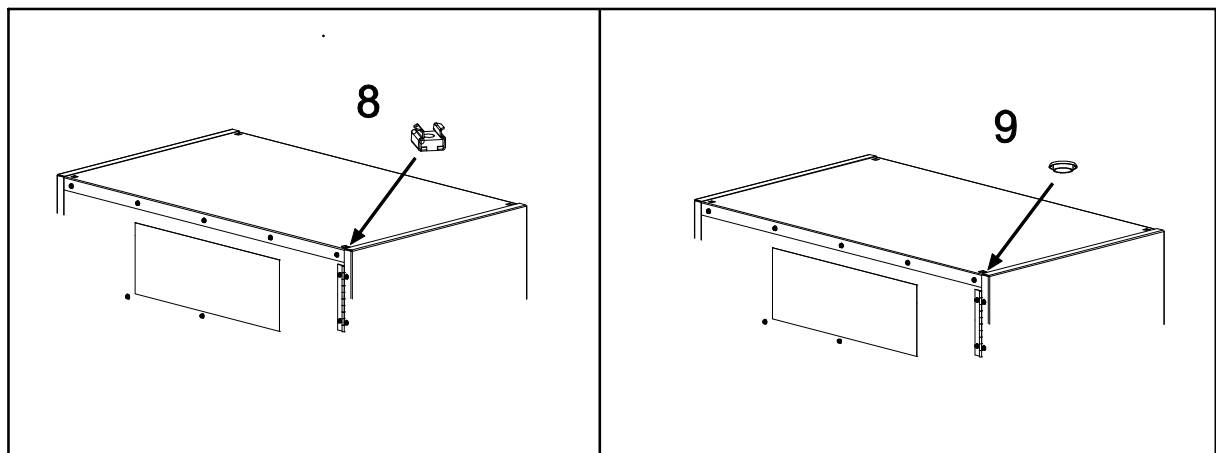

10. Fold all four tabs of the outdoor cover panel inward as shown.
11. Place the outdoor cover panel over the top of the heater so that it will slope away from the duct assembly side of the heater. Secure the cover panel using (8) #8 x 1/2" self-drilling screws supplied in the fastener kit (four in the front and four in the rear).

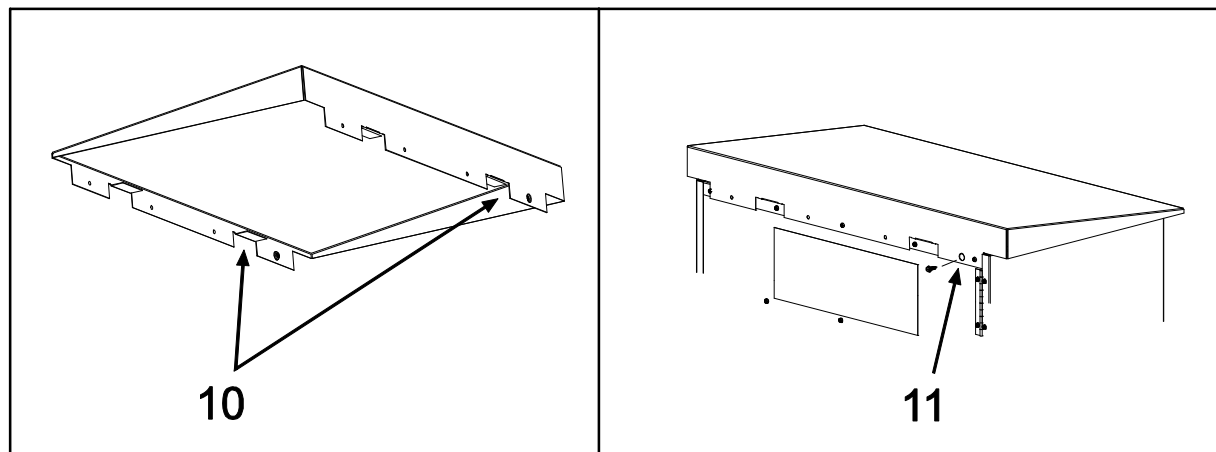

## MARKING THE MOUNTING BRACKET AND DUCT ASSEMBLY LOCATIONS

12. Use the dimensions shown below in the diagram to measure and mark the desired location where the heater will be mounted. Identify the duct assembly location, wall mounting brackets locations (can be installed at wall stud centers of 16 in or 24 in) and bottom of heater (must be a minimum of 24 in from the ground).

Drill the (4) holes as shown in the diagram 12 for location of the duct assembly. Draw lines connecting these holes. Cut out the opening for the duct. Note: There should be approximately 1/2 in. (12.7mm) clearance around the perimeter of the duct assembly after installation.

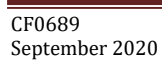



**13.** Pre-assemble the wall support brackets as shown in 13 using the 3/8"-16 x 1/2" screws, lockwashers and nuts supplied in the fastener kit.

**13a.** Place the wall mounting brackets at the centers marked earlier and temporarily secure using small nails. The top holed flanges must align with the bottom of the heater as identified in 12.

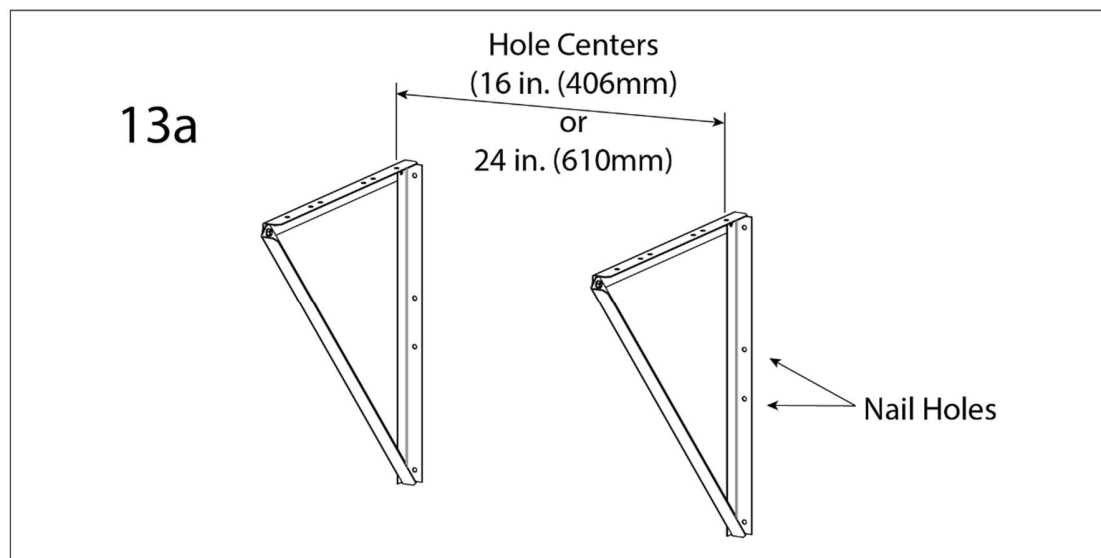
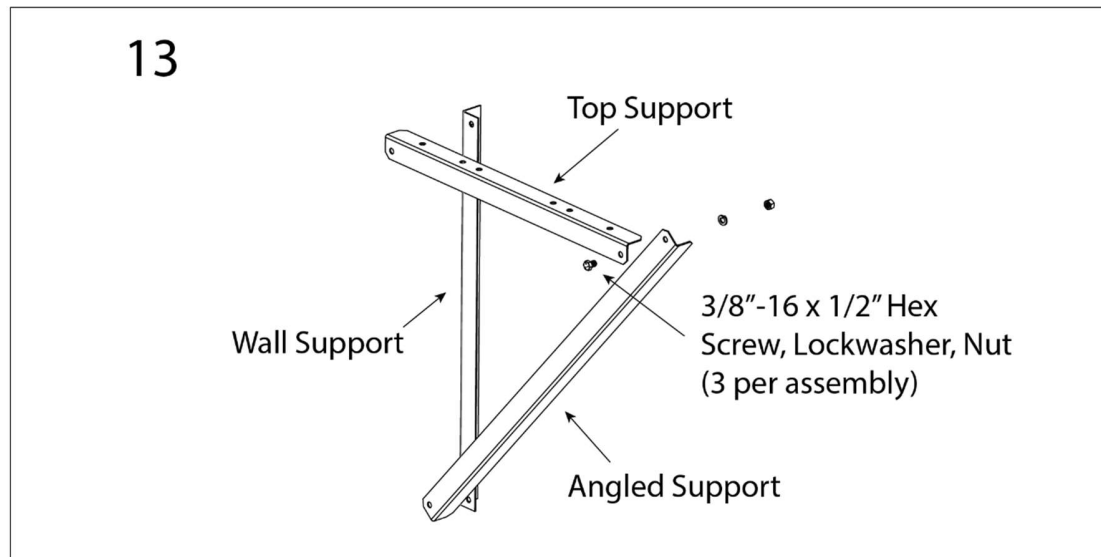

14. Make sure that the brackets are plumb and level. Drill pilot holes at the mounting holes. Secure the brackets to the wall using the (4) 3/8 in. x 4 in. long lag screws and washers supplied in the fastener kit. Check the brackets with a level and tighten the screws.

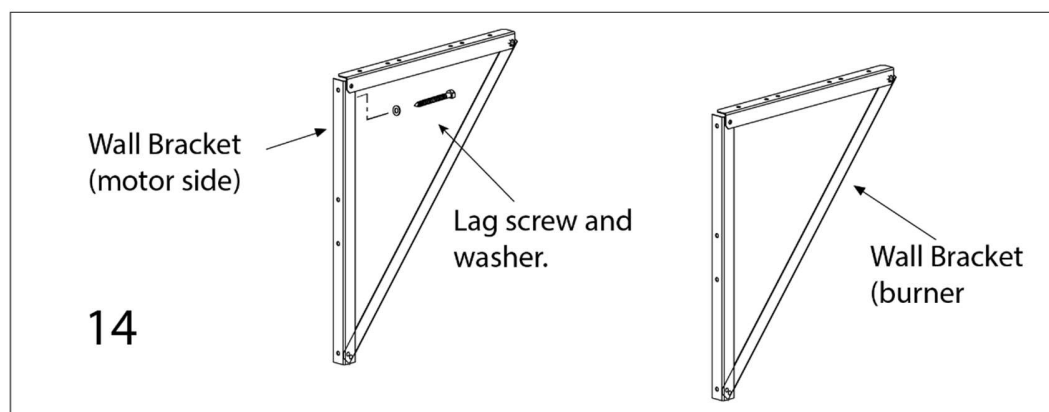

### INSTALLING THE HEATER ON THE HANGER BRACKETS

15. The heater can now be lifted up and placed onto the brackets while sliding the duct assembly portion through the wall opening cut earlier. **CAUTION:** The combined weight of the heater and the duct assembly is approximately 157 lbs. (71.2kg) and will require two or three people to lift it.

Note: That there are multiple hole patterns (16 in. and 24 in. centers) in the heater base plate to allow for the building walls stud centers marked earlier.

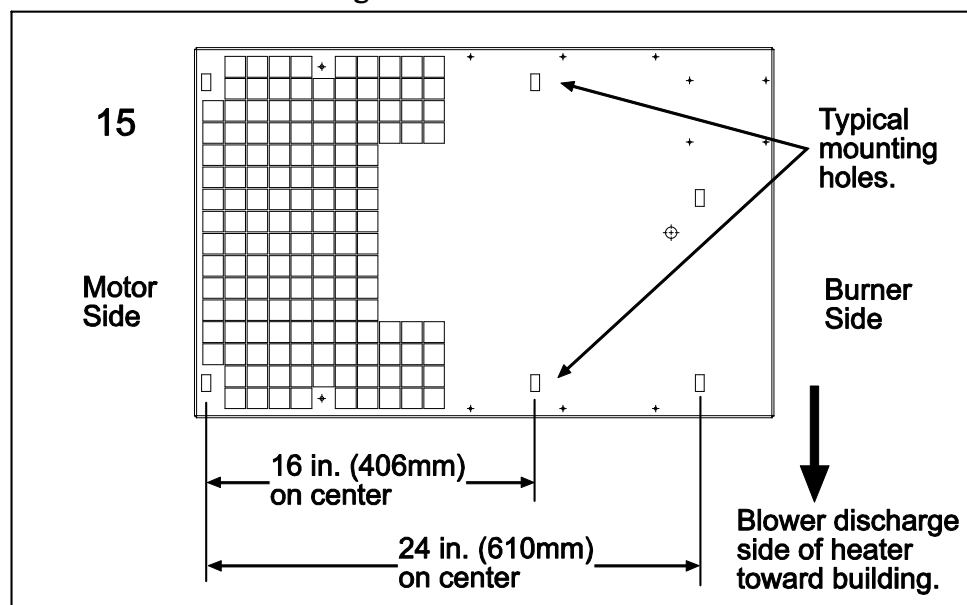

16. Position the heater so that the duct assembly extends beyond the inside wall surface and the heater base mounting holes (see 15) align with a top hole of the wall mounting bracket flange (see 13a). Insert spacers between the holes of the heater base and the hanger brackets. Secure the heater to the hanger brackets using the (4) 3/8-16 x 1-3/4" carriage bolts, nuts and washers supplied in the fastener kit.
17. Make sure that the minimum clearances of the heater at ground level and between the wall are as shown.
  - a. Use non-combustible insulation and fill in around the duct assembly opening and the wall.
  - b. Use a waterproof caulk and seal around the perimeter of the opening for the duct assembly.
  - c. Fold the optional duct trim pieces around the duct assembly with the flanges facing toward the inside wall. Secure each with #8 x 3/4" sheet metal screws supplied in the fastener kit. Fill the trim openings with silicone or other construction adhesive.
  - d. Connect gas and electrical supplies to the heater and test as per all instructions outlined in the heater manual. Check that the dampers open and close completely when the heater is in operating and off.
  - e. Keep these instructions for future reference.

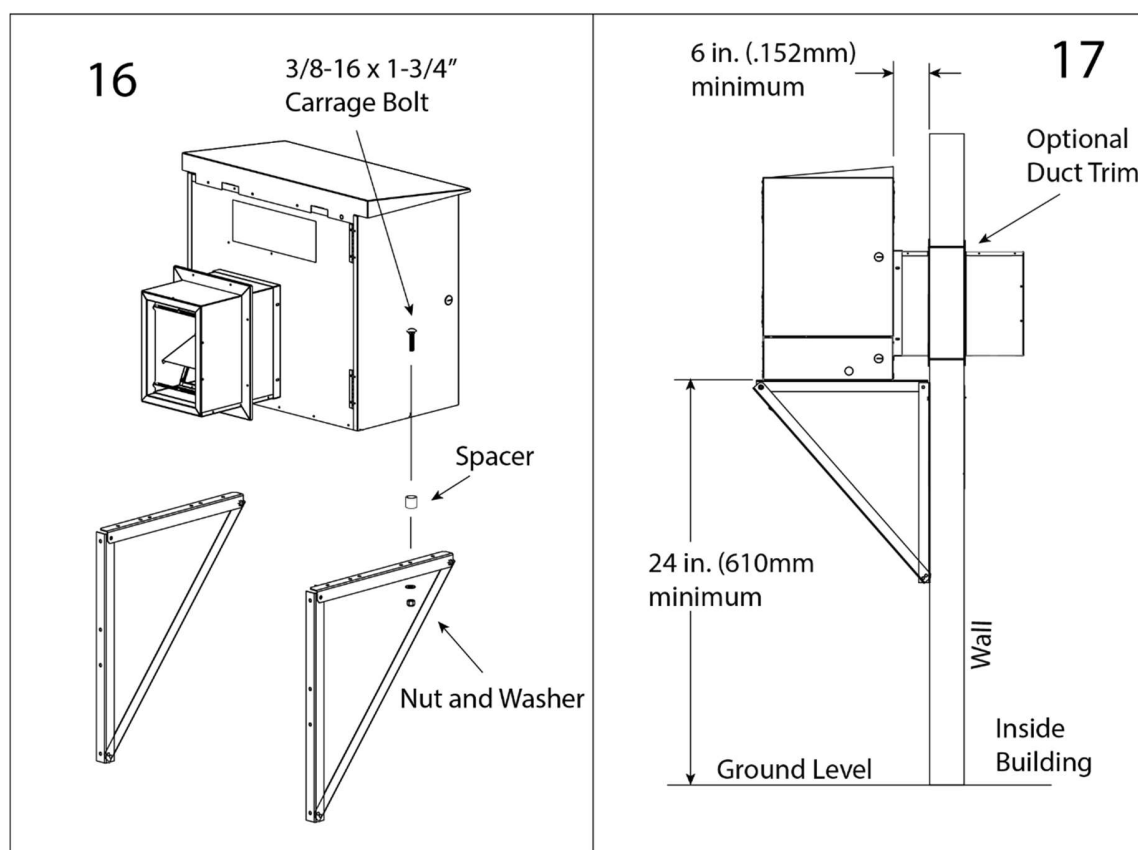

**Kromschroeder SA.**

**Santa Eulalia, 213 - 08902 L´Hospitalet de Llobregat - Barcelona - España**

**Phone: +34 93 432 9600 Fax: +34 93 422 0090 –**

**E-mail: [info@kromschroeder.es](mailto:info@kromschroeder.es) [www.kromschroeder.es](http://www.kromschroeder.es)**